

SPECIFICATION FOR APPROVAL



Date: 2016/11/7

Customer:

Customer P/N:

Description: SHIELDED POWER INDUCTOR

Part No.: HSEC1309L SERIES

File No.:

Revision:

如蒙承认，请予签回，谢谢！

Please sign and return this copy after evaluation, Thanks!

Customer Approved

DRAWING		
Approved	Checked	Drawn
Jun	Daniel	Linda

ADD: Minfu Road 20 , Shajing Street, Baoan District, Shenzhen, GuangDong, PRC

Tel: +86 135 3425 8018

Fax: +86 755 8947 1310

Email: cicely@szhighstar.com

SPECIFICATION FOR APPROVAL



Date: 2016/11/7

Customer		File No.	
Description	SHIELDED POWER INDUCTOR	Part No.	HSEC1309L SERIES
Customer P/N		Revision	

1. MECHANICAL DIMENSION (UNIT: mm)

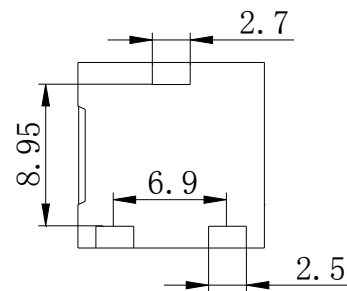
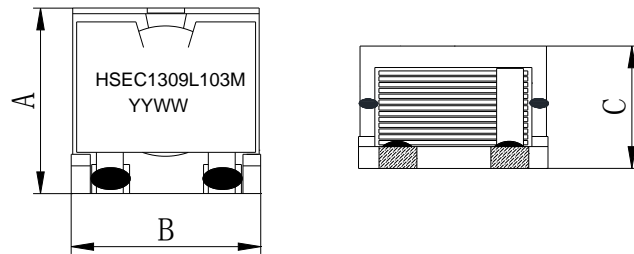

A	B	C
12.5±0.4	13.0±0.4	9.0Max

Note:

- 1 Rohs compliance
- 2 Class F
- 3 Operation teperature: -40 °C ----125°C
- 4
- 5

SPECIFICATION FOR APPROVAL



Date: 2016/11/7

Customer		File No.				
Description	SHIELDED POWER INDUCTOR	Part No.	HSEC1309L SERIES			
Customer P/N		Revision				
2. SCHEMATIC		3. WINDING				
PART NUMBER	Terminal		Wires Gauge	Turns	Insulation Tape	marking(black)
	Start	Finish				
HSEC1309L103M	1	2	0.3*1.8mm	15Ts		
HSEC1309L153M	1	2	0.3*1.8mm	15Ts		
HSEC1309L223M	1	2	0.25*1.8mm	17Ts		
HSEC1309L333M	1	2	0.25*1.8mm	17Ts		
HSEC1309L473M	1	2	0.25*1.8mm	17Ts		
<p>Note:</p> <p>1 Base and core fixed with glue.</p> <p>2 Tinned coil end and the base terminal welding.</p> <p>3</p> <p>4</p>						

SPECIFICATION FOR APPROVAL



Date: 2016/9/17

Customer		File No.	
Description	SHIELDED POWER INDUCTOR	Part No.	HSEC1309L SERIES
Customer P/N		Revision	

4. ELECTRICAL SPECIFICATION(25°C)

PART NUMBER	L(μ H) +/-20%	DCR(mohm) max	Isat(A) 20% drop	SRF (MHz) REF	Irms(A)	
					20°C rise	40°C rise
HSEC1309L103M	10	15	12.0	26.9	6.4	9.2
HSEC1309L153M	15	15	8.04	24.3	6.4	9.2
HSEC1309L223M	22	23.1	6.8	20.3	5.7	7.7
HSEC1309L333M	33	23.1	4.4	15.7	5.7	7.7
HSEC1309L473M	47	23.1	3	13.2	5.7	7.7

Test Condition: 100KHz/0.1V

5. MATERIAL LIST:

PART	DESCRIPTION	SUPPLIERS	UL NO.	
Core	Ferrite core	ER Core ACME or EQU		
Wire	Enamelled copper	JT or EQU		
Base	Metal Base	LS-B019 LIANCHENG or EQU		
Adhesive	Epoxy resin	G500 RUILANG or EQU		
Ternimal	Sn/Cu	THOUSAND or EQU		



SPECIFICATION FOR APPROVAL

Packing

Carrier Tape (Unit:mm)

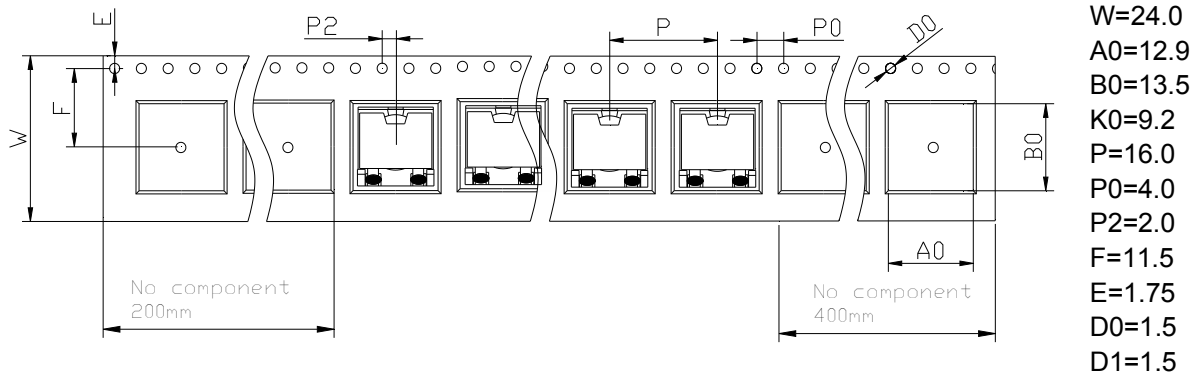

透明载带+透明自粘上带.

Reel (Unit:mm)

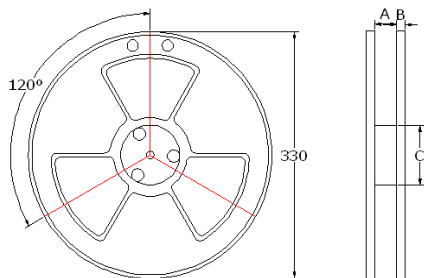

A=24.5
B=2.3
C=100

QTY

Reel(Pcs) 350
Middle Carton(Pcs) 700
Big Carton(Pcs) 3,500
N.W(Kg)
G.W(Kg)

350PCS/Reel

1Reel/Bag

2Bags/Small Box

5Small Boxes/Outer Box

