

# SHENZHEN HIGHSTARTECH ELECTRONICS CO.,LTD

## EFD SERIES

### 1. FEATURES:

- (1) Lower power loss and higher work effectivity..
- (2) High Bs and lower raise temperature.
- (3) High application fequency and width range work frequency.
- (4) Exact application voltage and lower leakage inductance.
- (5) Compliance with EN60950 and EN60065 ans EN61558.

### 2. APPLICATIONS:

- (1) SMPS.
- (2) Communication equipment/electrical equipment and meter.
- (3) Household appliances/computer and so on.

### 3. PART NUMBER SYSTEM:

HSTXXEFD-XXXX

XXEFD-----core dimension and type, e.g. 20EFD

XXXX----- series number

### 4. PHYSICAL CHARACTERISTICS:

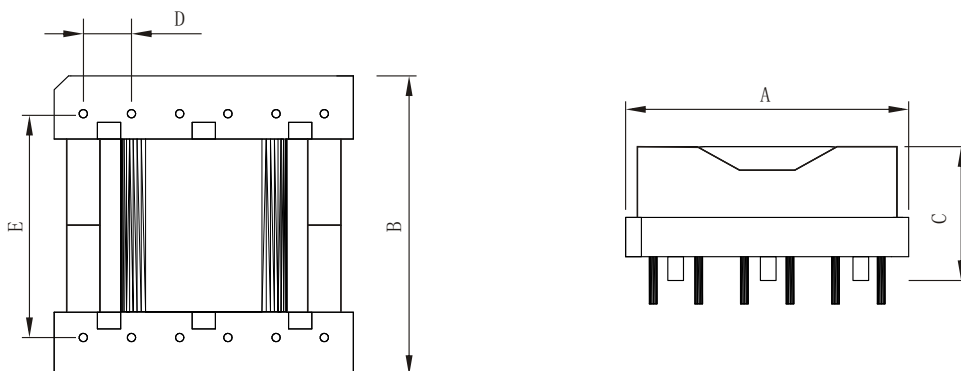

Type H

# SHENZHEN HIGHSTARTECH ELECTRONICS CO.,LTD

## EFD SERIES

### 5. ELECTRICAL CHARACTERISTICS:

Part number	Type	Pin number	Dimension(mm)						MAX output power (VA)
			MAX	MAX	MAX	±0.3	±0.5	±0.1	
			A	B	C	D	E	F	
HST15EFD-A	H	8	17	18	9.5	3.7	13.7	0.6	5
HST15EFD-B	H	8	17	18	9.5	3.75	13.75	0.6	5
HST15EFD-C	H	8	17	18	9.5	3.8	13.7	0.6	5
HST20EFD-A	H	8	22	23	11	5.0	17.5	0.6	18
HST20EFD-B	H	9	22	23	11	5.0	17.5	0.6	18
HST20EFD-C	H	10	22	26	15	3.8	23.8	0.6	18
HST25EFD-A	H	10	27	28	13	5.0	22.45	0.8	45
HST25EFD-B	H	10	27	28	15	5.0	22.5	0.8	45
HST30EFD-A	H	12	32	33	14	5.0	27.4	0.8	70
HST30EFD-B	H	12	32	36	18	5.0	30	0.8	70
HST30EFD-C	H	12	32	37	14	5.0	32	0.8	70