

SHENZHEN HIGHSTARTECH ELECTRONICS CO., LTD

Common Mode Choke

1. FEATURES:

- (1) Line filters suppressing conductive noise ranging from low to high frequencies generated at power supply circuits of various electronic equipment.
- (2) High safety and reliability .
- (3) 130 degree or 155 degree or 180 degree UEW-NY/PEW/EIW wire.
- (4) Easy PC board mounting .
- (5) Customer's specifications are welcome.

2. APPLICATIONS:

- (1) Minimizes noise emissions for conforming to FCC, VCCI, FTZ, CISPR, JTTC and VDE.
- (2) Applied equipment: TV, VCR, Switching Power sources, NC machines, computer systems. Peripheral units and measuring instruments.

3. PART NUMBER SYSTEM:

HSLF V - 102 U - 2A

(1) (2) (3) (4) (5)

- (1) Type, Line Filter.
- (2) Style, "V" is vertical structure, "H" is horizontal structure.
- (3) Inductance, e.g. 101 is for 100uH.
- (4) Inductance tolerance, U means minimum.
- (5) Rated current, e.g. 2A

SHENZHEN HIGHSTARTECH ELECTRONICS CO., LTD

Common Mode Choke

4. PHYSICAL CHARACTERISTICS:

HSLFV/HSLFT/HSLFTB TYPE

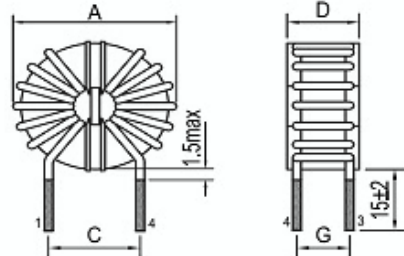

LFV type figure 1 (T core with plastic case)

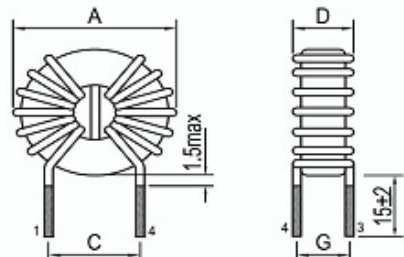

LFT type figure 2 (T core with paint coating)

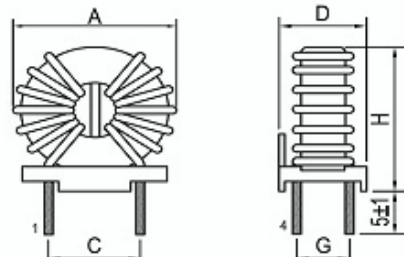

LFTB type figure 3 (LFT type with base)

Part Number	Dimension(mm)				Fig
	A max	D max	C	G	
HSLFV1209	17.5	14.5	5 typ	10 typ	Figure1
HSLFV1709	23	15	13 typ	12 typ	
HSLFV2208	30	15	13 typ	12 typ	
HSLFV2513	34	20	20 typ	18 typ	
HSLFV3113	40	20	20 typ	18 typ	
HSLFV3715	45	23	25 typ	20 typ	
HSLFT1206	16	10	10 typ	8 typ	Figure2
HSLFT1608	20	12	13 typ	10 typ	

SHENZHEN HIGHSTARTECH ELECTRONICS CO., LTD

Common Mode Choke

HSLFT2208	27	12.5	13 typ	10 typ	Figure2
HSLFT2513	30	18	20 typ	15 typ	
HSLFT3113	37	19	20 typ	15 typ	
HSLFT3715	43	21	25 typ	18 typ	
HSLFTB1206	17.5	14.5	10+/-1	8+/-1	Figure3
HSLFTB1608	23	15	15+/-1	10+/-1	
HSLFTB2208	30	16	20.3+/-1	10.2+/-1	
HSLFTB2513	34	21	23+/-1	15.2+/-1	
HSLFTB3113	40	21	23+/-1	15.2+/-1	
HSLFTB3715	45	24	30.5+/-1	17.8+/-1	

SHENZHEN HIGHSTARTECH ELECTRONICS CO., LTD

Common Mode Choke

HSLFH/HSLFC/HSLFLH/HSLFLV/HSLFTH TYPE

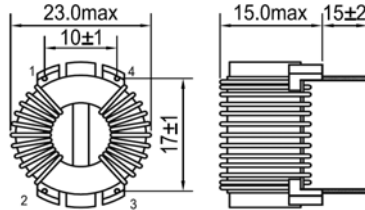

HSLFH type

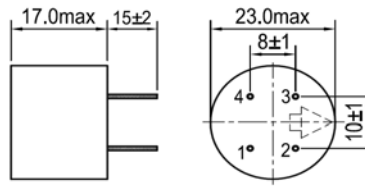

HSLFC type

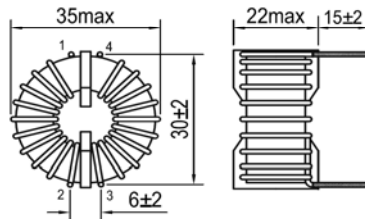

HSLFLH type (T core with plastic case)

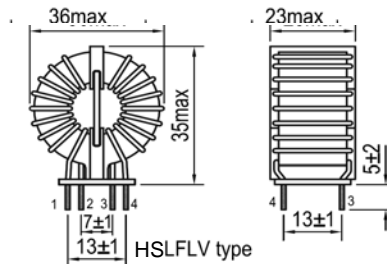

HSLFLV type

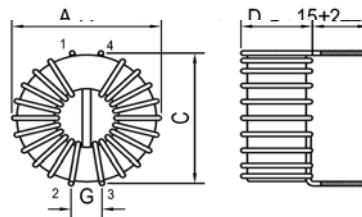

HSLFTH type (T core with paint coating)

Part Number	A(max)	D(max)	C(Ref)	G(Ref)
HSLFTH2208	27	13	24	6.0
HSLFTH2508	30	13	27	6

SHENZHEN HIGHSTARTECH ELECTRONICS CO., LTD

Common Mode Choke

HSLFU/HSLFUT TYPE

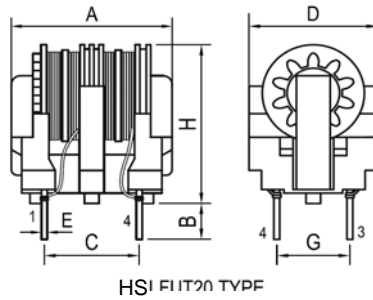
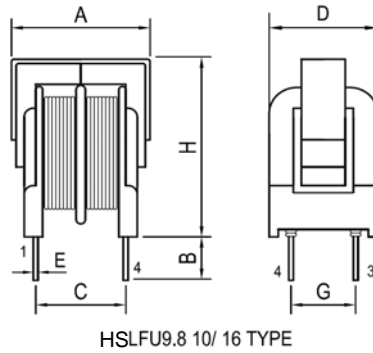
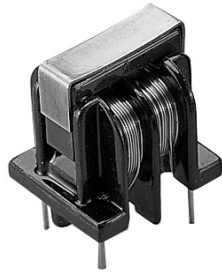
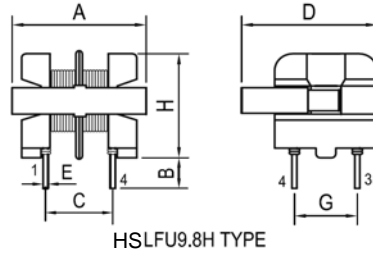

Part Number	A(max)	B+/-1	C+/-0.5	D(max)	E+/-0.05	G+/-0.5	H(max)
HSLFU9.8	17	4	8	12	0.6	7	17
HSLFU9.8H	17	4	8	16	0.6	7	13
HSLFU10	19	4	13	17	0.7	10	22
HSLFU16	23	4	13	19.5	0.7	10	27.5
HSLFUT20	22	4	13	17.5	0.8	10	23.5

SHENZHEN HIGHSTARTECH ELECTRONICS CO., LTD

Common Mode Choke

5. ELECTRICAL CHARACTERISTICS:

HSLFV/HSLFT/HSLFTB TYPE

Part Number	L(mH)	Rated Current A	DCR (mohm)	Part Number	L(mH)	Rated Current A	DCR (mohm)
	Min		Max		Min		Max
HSLFV1209-601U-1A	0.6	1	60	HSLFT2208-601U-8A	0.6	8	9.1
HSLFV1209-601U-2A	0.6	2	50	HSLFT2208-102U-6A	1	6	15
HSLFV1209-601U-3A	0.6	3	30	HSLFT2208-202U-6A	2	6	25
HSLFV1209-102U-1A	1	1	70	HSLFT2208-302U-5A	3	5	35
HSLFV1209-102U-2A	1	2	50	HSLFT2208-502U-4A	5	4	45
HSLFV1209-102U-3A	1	3	35	HSLFT2208-103U-3A	10	3	85
HSLFV1209-202U-1A	2	1	100	HSLFT2513-201U-15A	0.2	15	5
HSLFV1209-202U-2A	2	2	70	HSLFT2513-601U-8A	0.6	8	15
HSLFV1209-302U-2A	3	2	85	HSLFT2513-102U-5A	1	5	25
HSLFV1209-502U-1A	5	1	150	HSLFT2513-152U-5A	1.5	3	30
HSLFV1709-102U-2A	1	2	80	HSLFT2513-302U-5A	3	5	35
HSLFV1709-202U-2A	2	2	110	HSLFT2513-502U-3A	5	3	70
HSLFV1709-302U-2A	3	2	150	HSLFT3113-601U-15A	0.6	15	7
HSLFV1709-502U-1A	5	1	200	HSLFT3113-102U-10A	1	10	20
HSLFV1709-802U-1A	8	1	230	HSLFT3113-302U-6A	3	6	90
HSLFV1709-103U-1A	10	1	260	HSLFT3113-502U-5A	5	5	100
HSLFT3715-102U-15A	1	15	8	HSLFT3113-103U-3A	10	3	180
HSLFT3715-332U-15A	3.3	15	10	HSLFT3715-103U-10A	10	10	28
HSLFT3715-502U-15A	5	15	15	HSLFT3715-153U-10A	15	10	33

SHENZHEN HIGHSTARTECH ELECTRONICS CO., LTD

Common Mode Choke

HSLFH/HSLFC/HSLFLH/HSLFLV/HSLFTH TYPE

Part Number	L(mH)	Rated Current	DCR (mohm)	Part Number	L(mH)	Rated Current	DCR (mohm)
	Min	A	Max		Min	A	Max
HSLFH-102U-2A	1	2	80	HSLFLV-152U-3A	1.5	3	45
HSLFH-202U-2A	2	2	110	HSLFLV-502U-3A	5	3	70
HSLFH-302U-2A	3	2	150	HSLFLV-102U-5A	1	5	25
HSLFH-502U-1A	5	1	200	HSLFLV-302U-5A	3	5	35
HSLFH-802U-1A	8	1	230	HSLFLV-601U-8A	0.6	8	15
HSLFH-103U-1A	10	1	260	HSLFLV-201U-15A	0.2	15	5
HSLFC-301U-2A	0.3	2	60	HSLFTH2208-601U-8A	0.6	8	9.1
HSLFC-601U-2A	0.6	2	80	HSLFTH2208-102U-6A	1	6	15
HSLFC-102U-2A	1	2	100	HSLFTH2208-202U-6A	2	6	25
HSLFC-152U-2A	1.5	2	105	HSLFTH2208-302U-5A	3	5	35
HSLFC-202U-2A	2	2	150	HSLFTH2208-502U-4A	5	4	45
HSLFC-302U-2A	3	2	180	HSLFTH2208-103U-3A	10	3	85
HSLFC-552U-2A	5.5	2	200	HSLFTH2208-151U-12A	0.15	12	8
HSLFLH-151U-12A	0.15	12	8	HSLFTH2208-301U-9A	0.3	9	15
HSLFLH-301U-9A	0.3	9	15	HSLFTH2208-601U-9A	0.6	9	20
HSLFLH-601U-9A	0.6	9	20	HSLFTH2208-102U-3A	1	3	50
HSLFLH-102U-3A	1	3	50	HSLFTH2208-302U-3A	3	3	80
HSLFLH-302U-3A	3	3	80				

SHENZHEN HIGHSTARTECH ELECTRONICS CO., LTD

Common Mode Choke

HSLFU/LFUT TYPE

Part Number	L(mH)	Rated Current	DCR (ohm)	Part Number	L(mH)	Rated Current	DCR (ohm)
	Min	A	Max		Min	A	Max
HSLFU9.8-103U-0.1A	10	0.1	8	HSLFU16-103U-0.6A	10	0.6	1.2
HSLFU9.8-802U-0.2A	8	0.2	6	HSLFU16-802U-0.8A	8	0.8	0.8
HSLFU9.8-502U-0.2A	5	0.2	4.5	HSLFU16-602U-0.8A	6	0.8	0.7
HSLFU9.8-502U-0.3A	5	0.3	3.5	HSLFU16-602U-1A	6	1	0.5
HSLFU9.8-202U-0.5A	2	0.5	1	HSLFU16-402U-1A	4	1	0.4
HSLFU9.8-501U-1A	0.5	1	0.3	HSLFU16-352U-1.2A	3.5	1.2	0.3
HSLFU10-103U-0.3A	10	0.3	3	HSLFU16-252U-1.2A	2.5	1.2	0.25
HSLFU10-502U-0.3A	5	0.3	2	HSLFU16-152U-1.5A	1.5	1.5	0.15
HSLFU10-502U-0.5A	5	0.5	1.5	HSLFUT20-333U-0.3A	33	0.3	2.5
HSLFU10-402U-0.7A	4	0.7	1	HSLFUT20-223U-0.4A	22	0.4	1.7
HSLFU10-302U-1A	3	1	0.5	HSLFUT20-153U-0.5A	15	0.5	1.2
HSLFU10-202U-1A	2	1	0.5	HSLFUT20-103U-0.7A	10	0.7	0.75
HSLFU10-102U-1A	1	1	0.4	HSLFUT20-682U-0.8A	6.8	0.8	0.53
HSLFU10-102U-1.3A	1	1.3	0.3	HSLFUT20-472U-1A	4.7	1	0.38
HSLFU10-102U-1.5A	1	1.5	0.2	HSLFUT20-332U-1A	3.3	1	0.31
HSLFU10-601U-2A	0.6	2	0.2	HSLFUT20-222U-1.2A	2.2	1.2	0.18
HSLFU16-303U-0.4A	30	0.4	2.8	HSLFUT20-152U-1.5A	1.5	1.5	0.14
HSLFU16-203U-0.4A	20	0.4	2.2	HSLFUT20-751U-1.8A	0.75	1.8	0.12
HSLFU16-203U-0.5A	20	0.5	1.6				