

SHENZHEN HIGHSTARTECH ELECTRONICS CO., LTD

HSSFD SERIES

1. FEATURES:

Various high power inductors superior to be high saturation for surface mounting.

2. APPLICATIONS:

- (1) Power supply for VTR,OA equipment.
- (2) Digital camera, LCD television set.
- (3) Notebook PC, portable communication equipment.
- (4) DC/DC converters, etc.

3. PART NUMBER SYSTEM:

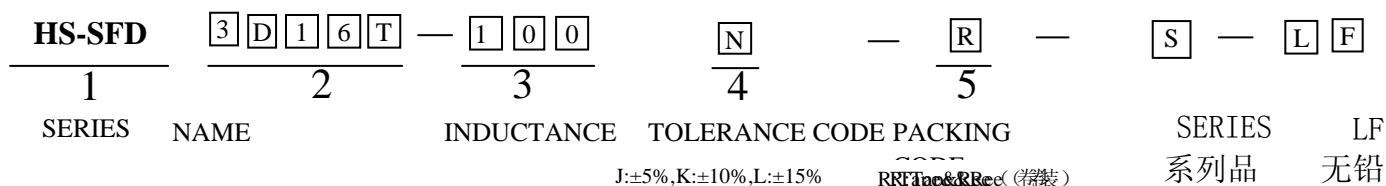

4. PHYSICAL CHARACTERISTICS:

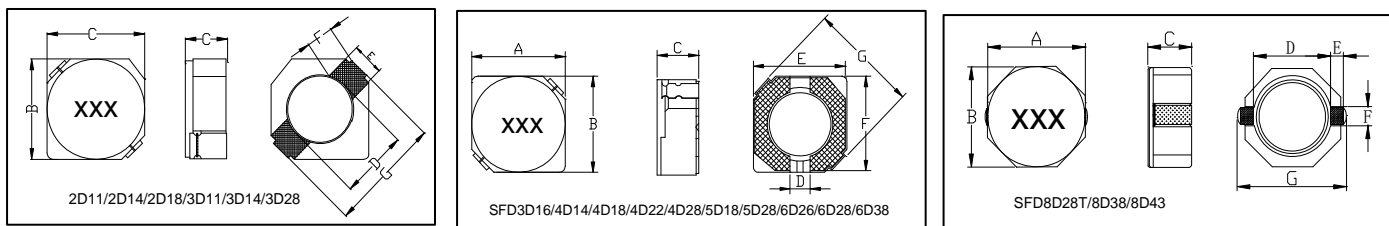

UNIT:(mm)

Type	A	B	C	D	E	F	G
HS-SFD2D11LD/HP	3.2max	3.2max	1.2max	2.1	1	0.7	4.5
HS-SFD2D14L	3.2max	3.2max	1.55max	2.1	1	0.7	4.5
HS-SFD2D18LD/HP	3.2max	3.2max	2.0max	2.1	1	0.7	4.5
HS-SFD3D11L	4.0max	4.0max	1.2max	2.8	1.1		5.2max
HS-SFD3D14HP	4.0max	4.0max	1.5max	2.8	1.1		5.2max
HS-SFD3D16T	4.0max	4.0max	1.8max	1.15	3.6	3.6	5.2max
HS-SFD3D16LD	4.0max	4.0max	1.8max	1.1	3.6	3.6	5.2max
HS-SFD3D16HP	4.0max	4.0max	1.8max	1.1	3.6	3.6	5.2max
HS-SFD3D28L	4.0max	4.0max	3.0max	2.8	1.1		5.2max
HS-SFD4D14HP	4.8max	4.8max	1.5max	1.5	4.5	4.5	6.2max
HS-SFD4D18T	5.0max	5.0max	2.0max	1.5	4.5	4.5	6.9max
HS-SFD4D22T	5.0max	5.0max	2.4max	1.5	4.5	4.5	6.9max
HS-SFD4D28T	5.0max	5.0max	2.4max	1.5	4.5	4.5	6.9max
HS-SFD5D18T	6.0max	6.0max	2.0max	2.0	5.5	5.5	8.2max
HS-SFD5D28T	6.0max	6.0max	3.0max	2	5.5	5.5	8.2max
HS-SFD6D26T	7.0max	7.0max	2.8max	2.0	6.5	6.5	9.5max
HS-SFD6D28T	7.0max	7.0max	3.0max	2	6.5	6.5	9.5max
HS-SFD6D38T	7.0max	7.0max	4.0max	2.0	6.5	6.5	9.5max
HS-SFD8D28T	8.3max	8.3max	3.0max	6.3	1.2	2.5	
HS-SFD8D38T	8.3max	8.3max	4.0max	6.3	1.2	2.5	

SHENZHEN HIGHSTARTECH ELECTRONICS CO., LTD

HSSFD SERIES

5. ELECTRICAL CHARACTERISTICS:

HS-SFD2D11LD SERIES

Part Number	Inductance (μ H)	DCR(max) (Ω)	IDC(A) (max) L/L=-35%; Δ t=40°C	Test Freq.
HS-SFD2D11LD-1R5N	1.5	0.068	0.9	100KHz
HS-SFD2D11LD-2R2N	2.2	0.098	0.78	100KHz
HS-SFD2D11LD-3R3N	3.3	0.123	0.6	100KHz
HS-SFD2D11LD-4R7N	4.7	0.170	0.5	100KHz
HS-SFD2D11LD-6R8N	6.8	0.26	0.44	100KHz
HS-SFD2D11LD-100N	10	0.4	0.35	100KHz

HS-SFD2D11HP SERIES

Part Number	Inductance (μ H)	DCR(max) (Ω)	IDC(A) (max) L/L=-35%; Δ t=40°C	Test Freq.
HS-SFD2D11HP-1R5N	1.5	0.08	1.35	100KHz
HS-SFD2D11HP-2R2N	2.2	0.12	1.1	100KHz
HS-SFD2D11HP-3R3N	3.3	0.173	0.9	100KHz
HS-SFD2D11HP-4R7N	4.7	0.238	0.75	100KHz
HS-SFD2D11HP-6R8N	6.8	0.371	0.63	100KHz
HS-SFD2D11HP-100N	10	0.559	0.52	100KHz

HS-SFD2D14L SERIES

Part Number	Inductance (μ H)	DCR(max) (Ω)	IDC(A) (max) L/L=-35%; Δ t=40°C	Test Freq.
HS-SFD2D14L-1R5N	1.5	0.063	1.8	100KHz
HS-SFD2D14L-2R2N	2.2	0.094	1.5	100KHz
HS-SFD2D14L-3R3N	3.3	0.125	1.2	100KHz
HS-SFD2D14L-4R7N	4.7	0.167	1	100KHz
HS-SFD2D14L-6R8N	6.8	0.213	0.85	100KHz
HS-SFD2D14L-100N	10	0.294	0.7	100KHz

SHENZHEN HIGHSTARTECH ELECTRONICS CO., LTD

HSSFD SERIES

HS-SFD2D18LD SERIES

Part Number	Inductance (μH)	DCR (max) (Ω)	IDC (A) (max) L/L=-35%; Δt=40°C	Test Freq.
HS-SFD2D18LD-2R2	2.2	0.041 (0.033)	0.850	100KHz
HS-SFD2D18LD-3R3	3.3	0.054 (0.043)	0.750	100KHz
HS-SFD2D18LD-4R7	4.7	0.078 (0.062)	0.630	100KHz
HS-SFD2D18LD-6R8	6.8	0.106 (0.085)	0.520	100KHz
HS-SFD2D18LD-100	10	0.180 (0.145)	0.430	100KHz
HS-SFD2D18LD-150	15	0.220 (0.175)	0.350	100KHz

HS-SFD2D18HP SERIES

Part Number	Inductance (μH)	DCR (max) (Ω)	IDC (A) (max) L/L=-35%; Δt=40°C	Test Freq.
HS-SFD2D18HP-1R7N	1.7	0.044	1.85	100KHz
HS-SFD2D18HP-2R2N	2.2	0.06	1.6	100KHz
HS-SFD2D18HP-3R3N	3.3	0.086	1.45	100KHz
HS-SFD2D18HP-4R7N	4.7	0.140	1.2	100KHz
HS-SFD2D18HP-6R8N	6.8	0.16	1.05	100KHz
HS-SFD2D18HP-100N	10	0.245	0.85	100KHz

HS-SFD3D11L SERIES

Parts No	L (μH)	D. C. R (Ω) : Max. (Typ)	Saturation Rated Current (A)*C	Temperature Rise Rated Current (A)*1V
HS-SFD3D11L-2R7	2.7	0.065	530	1.82
HS-SFD3D11L-4R7	4.7	0.095	400	1.38
HS-SFD3D11L-6R8	6.8	0.15	340	1.05
HS-SFD3D11L-8R2	8.2	0.190	320	0.950
HS-SFD3D11L-100	10	0.2	280	0.900
HS-SFD3D11L-120	12	0.23	250	0.810
HS-SFD3D11L-150	15	0.32	230	0.680
HS-SFD3D11L-180	18	0.4	210	0.580
HS-SFD3D11L-220	22	0.45	190	0.530
HS-SFD3D11L-270	27	0.65	170	0.480
HS-SFD3D11L-330	33	0.7	150	0.410
HS-SFD3D11L-390	39	0.85	140	0.400

SHENZHEN HIGHSTARTECH ELECTRONICS CO., LTD

HSSFD SERIES

HS-SFD3D14HP SERIES

Parts No	L (μ H)	D. C. R (Ω): max. (Typ)	Saturation Rated Current (A)*C		Temperature Rise Rated Current (A)*1V
			20°C	100°C	
			HS-SFD3D14HP-1R5__	1.5	
HS-SFD3D14HP-2R4__	2.4	0.129(0.103)	2.00	1.50	1.32
HS-SFD3D14HP-3R2__	3.2	0.139(0.111)	1.80	1.30	1.25
HS-SFD3D14HP-4R7__	4.7	0.214(0.19)	1.40	1.00	1.04
HS-SFD3D14HP-6R8__	6.8	0.290(0.26)	1.20	0.900	0.84
HS-SFD3D14HP-8R2__	8.2	0.440(0.3)	1.05	0.720	0.67
HS-SFD3D14HP-100__	10	0.650(0.34)	0.96	0.600	0.5
HS-SFD3D14HP-150__	15	0.830(0.505)	0.79	0.480	0.48

HS-SFD3D16T SERIES

Part Number	Inductance (μ H)	DCR(max) (Ω)	IDC(A) (max) $\Delta L/L=-35\%; \Delta t=40$ $^{\circ}$ C	Test Freq.
HS-SFD3D16T-1R5N	1.5	0.052	1.55	100KHz
HS-SFD3D16T-2R2N	2.2	0.072	1.2	100KHz
HS-SFD3D16T-3R3N	3.3	0.085	1.1	100KHz
HS-SFD3D16T-6R8N	6.8	0.260	0.44	100KHz
HS-SFD3D16T-6R8N	6.8	0.17	0.73	100KHz
HS-SFD3D16T-100N	10	0.21	0.55	100KHz
HS-SFD3D16T-150N	15	0.295	0.45	100KHz
HS-SFD3D16T-220N	22	0.43	0.4	100KHz
HS-SFD3D16T-330N	33	0.675	0.32	100KHz

HS-SFD3D16LD SERIES

Part Number	Inductance (μ H)	DCR(max) (Ω)	IDC(A) (max) $\Delta L/L=-35\%; \Delta t=40$ $^{\circ}$ C	Test Freq.
HS-SFD3D16LD-3R3__	3.3	0.066(0.053)	0.8	100KHz
HS-SFD3D16LD-3R9__	3.9	0.081(0.065)	0.75	100KHz
HS-SFD3D16LD-4R7__	4.7	0.091(0.073)	0.68	100KHz
HS-SFD3D16LD-5R6__	5.6	0.115(0.082)	0.62	100KHz

SHENZHEN HIGHSTARTECH ELECTRONICS CO., LTD

HSSFD SERIES

HS-SFD3D16LD-6R8__	6.8	0.130 (0.104)	0.58	100KHz
HS-SFD3D16LD-8R2__	8.2	0.168 (0.112)	0.51	100KHz
HS-SFD3D16LD-10__	10	0.190 (0.152)	0.46	100KHz
HS-SFD3D16LD-120__	12	0.246 (0.164)	0.42	100KHz
HS-SFD3D16LD-150__	15	0.272 (0.218)	0.38	100KHz

SHENZHEN HIGHSTARTECH ELECTRONICS CO., LTD

HSSFD SERIES

HS-SFD3D16HP SERIES

Part Number	Inductance (μ H)	DCR(max) (Ω)	IDC(A) (max) Δ L/L=-35%; Δ t=40°C	Test Freq.
HS-SFD3D16HP-1R7__	1.7	0.051(0.041)	2.00	100KHz
HS-SFD3D16HP-2R2__	2.2	0.059(0.047)	1.75	100KHz
HS-SFD3D16HP-3R3__	3.3	0.085(0.068)	1.40	100KHz
HS-SFD3D16HP-3R9__	3.9	0.116(0.093)	1.20	100KHz
HS-SFD3D16HP-4R7__	4.7	0.116(0.145)	1.20	100KHz
HS-SFD3D16HP-5R6__	5.6	0.230(0.185)	0.84	100KHz
HS-SFD3D16HP-6R8__	6.8	0.18(0.328)	1.00	100KHz
HS-SFD3D16HP-8R2__	8.2	0.610(0.488)	0.55	100KHz
HS-SFD3D16HP-100__	10	0.27(0.695)	0.84	100KHz

HS-SFD3D28L SERIES

Part Number	Inductance (μ H)	DCR(max) (Ω)	IDC(A) (max) Δ L/L=-35%; Δ t=40°C	Test Freq.
HS-SFD3D28L-1R7__	1.7	0.0721(0.0577)	2.00	100KHz
HS-SFD3D28L-3R3__	3.3	0.0883(0.0706)	1.65	100KHz
HS-SFD3D28L-4R7__	4.7	0.0883(0.0950)	1.65	100KHz
HS-SFD3D28L-6R8__	6.8	0.145(0.116)	1.05	100KHz
HS-SFD3D28L-100__	10	0.213(0.170)	0.90	100KHz
HS-SFD3D28L-150__	15	0.335(0.268)	0.76	100KHz
HS-SFD3D28L-220__	22	0.335(0.385)	0.58	100KHz
HS-SFD3D28L-330__	33	0.599(0.479)	0.48	100KHz

SHENZHEN HIGHSTARTECH ELECTRONICS CO., LTD

HSSFD SERIES

HS-SFD4D14HP SERIES

Part Number	Inductance (μ H)	DCR (max) (Ω)	IDC(A) (max) $\Delta L/L=-35\%; \Delta t=40^{\circ}\text{C}$	Test Freq.
HS-SFD4D14HP-4R7	4.7	0.140 (0.115)	1.10	100KHz
HS-SFD4D14HP-6R8	6.8	0.190 (0.155)	0.92	100KHz
HS-SFD4D14HP-100	10	0.280 (0.230)	0.75	100KHz

HS-SFD4D18T SERIES

Part Number	Inductance (μ H)	DCR (max) (Ω)	IDC(A) (max) $\Delta L/L=-35\%; \Delta t=40^{\circ}\text{C}$	Test Freq.
HS-SFD4D18T-1R0N	1	0.045	1.72	7.96MHz
HS-SFD4D18T-2R2N	2.2	0.075	1.32	7.96MHz
HS-SFD4D18T-2R7N	2.7	0.105	1.28	7.96MHz
HS-SFD4D18T-3R3N	3.3	0.11	1.04	7.96MHz
HS-SFD4D18T-3R9N	3.9	0.155	0.88	7.96MHz
HS-SFD4D18T-4R7N	4.7	0.162	0.84	7.96MHz
HS-SFD4D18T-5R6N	5.6	0.17	0.8	7.96MHz
HS-SFD4D18T-6R8N	6.8	0.200	0.76	7.96MHz
HS-SFD4D18T-8R2N	8.2	0.245	0.68	100KHz
HS-SFD4D18T-100N	10	0.2	0.61	100KHz
HS-SFD4D18T-120N	12	0.21	0.56	100KHz
HS-SFD4D18T-150N	15	0.24	0.5	100KHz
HS-SFD4D18T-180N	18	0.338	0.48	100KHz
HS-SFD4D18T-220N	22	0.397	0.41	100KHz
HS-SFD4D18T-270N	27	0.441	0.35	100KHz
HS-SFD4D18T-330N	33	0.694	0.32	100KHz
HS-SFD4D18T-390N	39	0.709	0.3	100KHz

SHENZHEN HIGHSTARTECH ELECTRONICS CO., LTD

HSSF D SERIES

HS-SFD4D22T SERIES

Part Number	Inductance (μ H)	DCR(max) (Ω)	IDC(A) (max) L/L=-35%; Δ t=40°C	Δ Test Freq.
HS-SFD4D22T-1R5	1.5	0.0183(0.0141)	2.00	100KHz
HS-SFD4D22T-1R8	1.8	0.0216(0.0166)	1.90	100KHz
HS-SFD4D22T-2R3	2.3	0.0254(0.0195)	1.80	100KHz
HS-SFD4D22T-3R3	3.3	0.0351(0.027)	1.40	100KHz
HS-SFD4D22T-3R9	3.9	0.0402(0.0309)	1.30	100KHz
HS-SFD4D22T-4R7	4.7	0.0559(0.0430)	1.10	100KHz
HS-SFD4D22T-5R6	5.6	0.0620(0.0477)	1.05	100KHz
HS-SFD4D22T-6R8	6.8	0.0880(0.0677)	1.00	100KHz
HS-SFD4D22T-8R2	8.2	0.0965(0.0742)	0.90	100KHz
HS-SFD4D22T-100	10	0.1024(0.0788)	0.80	100KHz
HS-SFD4D22T-120	12	0.1104(0.0849)	0.75	100KHz
HS-SFD4D22T-150	15	0.1274(0.0980)	0.68	100KHz
HS-SFD4D22T-180	18	0.1687(0.1298)	0.60	100KHz
HS-SFD4D22T-220	22	0.1997(0.1536)	0.54	100KHz
HS-SFD4D22T-270	27	0.2827(0.2173)	0.51	100KHz
HS-SFD4D22T-330	33	0.3258(0.2506)	0.48	100KHz
HS-SFD4D22T-390	39	0.4512(0.3471)	0.43	100KHz
HS-SFD4D22T-470	47	0.5004(0.3849)	0.38	100KHz
HS-SFD4D22T-560	56	0.5554(0.4272)	0.36	100KHz
HS-SFD4D22T-680	68	0.6341(0.4878)	0.33	100KHz
HS-SFD4D22T-820	82	0.7946(0.6089)	0.30	100KHz
HS-SFD4D22T-101	100	0.880(0.670)	0.25	100KHz
HS-SFD4D22T-121	120	1.140(0.880)	0.23	100KHz
HS-SFD4D22T-151	150	1.350(1.040)	0.21	100KHz

SHENZHEN HIGHSTARTECH ELECTRONICS CO., LTD

HSSFD SERIES

HS-SFD4D28T SERIES

Part Number	Inductance (μ H)	DCR(max) (Ω)	IDC(A) (max) Δ L/L=-35%; Δ t=40°C	Test Freq.
HS-SFD4D28T-1R2N	1.2	0.024	2.56	100KHz
HS-SFD4D28T-1R8N	1.8	0.028	2.20	100KHz
HS-SFD4D28T-2R2N	2.2	0.031	2.04	100KHz
HS-SFD4D28T-2R7N	2.7	0.043	1.60	100KHz
HS-SFD4D28T-3R3N	3.3	0.049	1.57	100KHz
HS-SFD4D28T-3R9N	3.9	0.065	1.44	100KHz
HS-SFD4D28T-4R7N	4.7	0.072	1.32	100KHz
HS-SFD4D28T-5R6N	5.6	0.101	1.17	100KHz
HS-SFD4D28T-6R8N	6.8	0.109	1.12	100KHz
HS-SFD4D28T-8R2N	8.2	0.118	1.04	100KHz
HS-SFD4D28T-100N	10	0.128	1.00	100KHz
HS-SFD4D28T-120N	12	0.132	0.84	100KHz
HS-SFD4D28T-150N	15	0.149	0.76	100KHz
HS-SFD4D28T-180N	18	0.166	0.72	100KHz
HS-SFD4D28T-220N	22	0.235	0.70	100KHz
HS-SFD4D28T-270N	27	0.261	0.58	100KHz
HS-SFD4D28T-330N	33	0.378	0.56	100KHz
HS-SFD4D28T-390N	39	0.384	0.50	100KHz
HS-SFD4D28T-470N	47	0.587	0.48	100KHz
HS-SFD4D28T-560N	56	0.625	0.41	100KHz
HS-SFD4D28T-680N	68	0.699	0.35	100KHz
HS-SFD4D28T-820N	82	0.915	0.32	100KHz
HS-SFD4D28T-101N	100	1.020	0.29	100KHz
HS-SFD4D28T-121N	120	1.27	0.27	100KHz
HS-SFD4D28T-151N	150	1.350	0.24	100KHz
HS-SFD4D28T-181N	180	1.54	0.22	100KHz

SHENZHEN HIGHSTARTECH ELECTRONICS CO., LTD

HSSFD SERIES

HS-SFD5D18T SERIES

Part Number	Inductance (μ H)	DCR(max) (Ω)	IDC(A) (max) Δ L/L=-35%; Δ t=40°C	Test Freq.
HS-SFD5D18T-4R1N	4.1	0.057	1.95	10KHz
HS-SFD5D18T-5R4N	5.4	0.076	1.60	10KHz
HS-SFD5D18T-6R2N	6.2	0.096	1.40	10KHz
HS-SFD5D18T-8R9N	8.9	0.116	1.25	10KHz
HS-SFD5D18T-100N	10	0.124	1.20	10KHz
HS-SFD5D18T-120N	12	0.153	1.10	10KHz
HS-SFD5D18T-150N	15	0.196	0.97	10KHz
HS-SFD5D18T-180N	18	0.21	0.85	10KHz
HS-SFD5D18T-220N	22	0.290	0.80	10KHz
HS-SFD5D18T-270N	27	0.33	0.75	10KHz
HS-SFD5D18T-330N	33	0.386	0.65	10KHz
HS-SFD5D18T-390N	39	0.52	0.57	10KHz
HS-SFD5D18T-470N	47	0.595	0.54	10KHz
HS-SFD5D18T-560N	56	0.665	0.5	10KHz
HS-SFD5D18T-680N	68	0.840	0.43	10KHz
HS-SFD5D18T-820N	82	0.978	0.41	10KHz
HS-SFD5D18T-101N	100	1.200	0.36	10KHz

SHENZHEN HIGHSTARTECH ELECTRONICS CO., LTD

HSSFD SERIES

HS-SFD5D28T SERIES

Part Number	Inductance (μ H)	DCR (max) (Ω)	IDC (A) (max) L/L=-35%; Δ t=40°C Δ	Test Freq.
HS-SFD5D28T-2R5N	2.5	0.018	2.60	10KHz
HS-SFD5D28T-3R0N	3	0.024	2.40	10KHz
HS-SFD5D28T-4R2N	4.2	0.031	2.20	10KHz
HS-SFD5D28T-5R3N	5.3	0.038	1.90	10KHz
HS-SFD5D28T-6R2N	6.2	0.045	1.80	10KHz
HS-SFD5D28T-8R2N	8.2	0.053	1.60	10KHz
HS-SFD5D28T-100N	10	0.065	1.30	10KHz
HS-SFD5D28T-120N	12	0.076	1.20	10KHz
HS-SFD5D28T-150N	15	0.103	1.1	10KHz
HS-SFD5D28T-180N	18	0.11	1.0	10KHz
HS-SFD5D28T-220N	22	0.122	0.9	10KHz
HS-SFD5D28T-270N	27	0.175	0.85	10KHz
HS-SFD5D28T-330N	33	0.189	0.75	10KHz
HS-SFD5D28T-390N	39	0.212	0.7	10KHz
HS-SFD5D28T-470N	47	0.250	0.62	10KHz
HS-SFD5D28T-560N	56	0.305	0.58	10KHz
HS-SFD5D28T-680N	68	0.355	0.52	10KHz
HS-SFD5D28T-820N	82	0.463	0.46	10KHz
HS-SFD5D28T-101N	100	0.520	0.42	10KHz

SHENZHEN HIGHSTARTECH ELECTRONICS CO., LTD

HSSFD SERIES

HS-SFD6D26T SERIES

Part Number	Inductance (μ H)	DCR(max) (Ω)	IDC(A) (max) Δ $I/I \leq -35\% \cdot \Delta t = 40^\circ\text{C}$	Test Freq.
HS-SFD6D26T-2R2__	2.2	0.022 (0.0162)	3.20	10KHz
HS-SFD6D26T-2R9__	2.9	0.025 (0.0187)	2.80	10KHz
HS-SFD6D26T-3R6__	3.6	0.029 (0.0213)	2.50	10KHz
HS-SFD6D26T-5R0__	5	0.032 (0.0234)	2.20	10KHz
HS-SFD6D26T-5R6__	5.6	0.036 (0.0265)	2.00	10KHz
HS-SFD6D26T-6R8__	6.8	0.054 (0.0400)	1.80	10KHz
HS-SFD6D26T-8R0__	8	0.060 (0.0440)	1.60	10KHz
HS-SFD6D26T-100__	10	0.071 (0.0528)	1.50	10KHz
HS-SFD6D26T-120__	12	0.078 (0.0574)	1.30	10KHz
HS-SFD6D26T-150__	15	0.106 (0.0786)	1.2	10KHz
HS-SFD6D26T-180__	18	0.114 (0.0842)	1.10	10KHz
HS-SFD6D26T-220__	22	0.129 (0.0954)	1.00	10KHz
HS-SFD6D26T-270__	27	0.185 (0.1366)	0.900	10KHz
HS-SFD6D26T-330__	33	0.203 (0.1502)	0.800	10KHz
HS-SFD6D26T-390__	39	0.223 (0.1652)	0.750	10KHz
HS-SFD6D26T-470__	47	0.300 (0.2216)	0.700	10KHz
HS-SFD6D26T-560__	56	0.340 (0.2514)	0.650	10KHz
HS-SFD6D26T-680__	68	0.347 (0.2570)	0.580	10KHz
HS-SFD6D26T-820__	82	0.490 (0.3640)	0.530	10KHz
HS-SFD6D26T-101__	100	0.560 (0.4148)	0.500	10KHz

SHENZHEN HIGHSTARTECH ELECTRONICS CO., LTD

HSSFD SERIES

HS-SFD6D28T SERIES

Part Number	Inductance (μ H)	DCR (max) (Ω)	IDC (A) (max) L/L=-35%; Δ t=40°C Δ	Test Freq.
HS-SFD6D28-3R0N	3.0	0.024	3.00	10KHz
HS-SFD6D28-3R9N	3.9	0.027	2.60	10KHz
HS-SFD6D28-5R0N	5.0	0.031	2.40	10KHz
HS-SFD6D28-6R0N	6.0	0.035	2.25	10KHz
HS-SFD6D28-7R3N	7.3	0.054	2.10	10KHz
HS-SFD6D28-8R6N	8.6	0.058	1.85	10KHz
HS-SFD6D28-100N	10	0.065	1.70	10KHz
HS-SFD6D28-120N	12	0.07	1.55	10KHz
HS-SFD6D28-150N	15	0.084	1.40	10KHz
HS-SFD6D28-180N	18	0.095	1.32	10KHz
HS-SFD6D28-220N	22	0.128	1.20	10KHz
HS-SFD6D28-270N	27	0.142	1.05	10KHz
HS-SFD6D28-330N	33	0.165	0.97	10KHz
HS-SFD6D28-390N	39	0.21	0.86	10KHz
HS-SFD6D28-470N	47	0.238	0.80	10KHz
HS-SFD6D28-560N	56	0.277	0.73	10KHz
HS-SFD6D28-680N	68	0.304	0.65	10KHz
HS-SFD6D28-820N	82	0.390	0.6	10KHz
HS-SFD6D28-101N	100	0.535	0.54	10KHz

SHENZHEN HIGHSTARTECH ELECTRONICS CO., LTD

HSSFD SERIES

HS-SFD6D38T SERIES

Part Number	Inductance (μ H)	DCR(max) (Ω)	IDC(A) (max) Δ L/L=-35%; Δ t=40 $^{\circ}$ C	Test Freq.
HS-SFD6D38T-3R3N	3.3	0.020	3.50	10KHz
HS-SFD6D38T-5R0N	5	0.024	2.90	10KHz
HS-SFD6D38T-6R2N	6.2	0.027	2.50	10KHz
HS-SFD6D38T-7R4N	7.4	0.031	2.30	10KHz
HS-SFD6D38T-8R7N	8.7	0.034	2.20	10KHz
HS-SFD6D38T-100N	10	0.038	2.00	10KHz
HS-SFD6D38T-120N	12	0.053	1.70	10KHz
HS-SFD6D38T-150N	15	0.057	1.60	10KHz
HS-SFD6D38T-180N	18	0.092	1.50	10KHz
HS-SFD6D38T-220N	22	0.096	1.30	10KHz
HS-SFD6D38T-270N	27	0.109	1.20	10KHz
HS-SFD6D38T-330N	33	0.124	1.10	10KHz
HS-SFD6D38T-390N	39	0.138	1.00	10KHz
HS-SFD6D38T-470N	47	0.155	0.95	10KHz
HS-SFD6D38T-560N	56	0.202	0.85	10KHz
HS-SFD6D38T-680N	68	0.234	0.75	10KHz
HS-SFD6D38T-820N	82	0.324	0.70	10KHz
HS-SFD6D38T-101N	100	0.358	0.65	10KHz

SHENZHEN HIGHSTARTECH ELECTRONICS CO., LTD

HSSFD SERIES

HS-SFD8D28T SERIES

Part Number	Inductance (μ H)	DCR (max) (Ω)	IDC (A) (max) Δ L/L=-35%; Δ t=40°C	Test Freq.
HS-SFD8D28T-2R5N	2.5	0.016	5.40	100KHz
HS-SFD8D28T-3R3N	3.3	0.018	4.00	100KHz
HS-SFD8D28T-4R7N	4.7	0.025	4.00	100KHz
HS-SFD8D28T-7R3N	7.3	0.039	3.20	100KHz
HS-SFD8D28T-100N	10	0.047	2.50	100KHz
HS-SFD8D28T-150N	15	0.069	1.90	100KHz
HS-SFD8D28T-220N	22	0.099	1.60	100KHz
HS-SFD8D28T-330N	33	0.156	1.40	100KHz
HS-SFD8D28T-470N	47	0.195	1.25	100KHz
HS-SFD8D28T-680N	68	0.286	0.92	100KHz
HS-SFD8D28T-101N	100	0.43	0.78	100KHz

HS-SFD8D38T SERIES

Part Numbetr	Inductance (μ H)	DCR (max) (Ω)	IDC (A) (max) Δ L/L=-35%; Δ t=40°C	Test Freq.
HS-SFD8D38T-2R0N	2	0.014	6.4	100KHz
HS-SFD8D38T-3R9N	3.9	0.019	5.0	100KHz
HS-SFD8D38T-4R7N	4.7	0.029	4.6	100KHz
HS-SFD8D38T-6R8N	6.8	0.025	3.2	100KHz
HS-SFD8D38T-100N	10	0.048	3	100KHz
HS-SFD8D38T-150N	15	0.067	2.75	100KHz
HS-SFD8D38T-220N	22	0.105	2.3	100KHz
HS-SFD8D38T-330N	33	0.125	1.6	100KHz
HS-SFD8D38T-470N	47	0.15	1.4	100KHz
HS-SFD8D38T-680N	68	0.24	1.2	100KHz
HS-SFD8D38T-101N	100	0.36	0.9	100KHz

SHENZHEN HIGHSTARTECH ELECTRONICS CO., LTD

HSSFD SERIES

HS-SFD8D43T SERIES

Part Number	Inductance (μ H)	DCR(max) (Ω)	IDC(A) (max) Δ L/L=-35%; Δ t=40°C	Test Freq.
HS-SFD8D43T-2R0N	2.0	0.014	7.0	100KHz
HS-SFD8D43T-3R9N	3.9	0.019	5.9	100KHz
HS-SFD8D43T-4R7N	4.7	0.022	4.6	100KHz
HS-SFD8D43T-6R8N	6.8	0.025	4.6	100KHz
HS-SFD8D43T-100N	10.0	0.036	2.6	100KHz
HS-SFD8D43T-150N	15	0.053	2.6	100KHz
HS-SFD8D43T-220N	22.0	0.075	2.1	100KHz
HS-SFD8D43T-330N	33	0.125	1.6	100KHz
HS-SFD8D43T-470N	47.0	0.15	1.8	100KHz
HS-SFD8D43T-680N	68	0.24	1.5	100KHz
HS-SFD8D43T-101N	100.0	0.36	1.3	100KHz

SHENZHEN HIGHSTARTECH ELECTRONICS CO., LTD

HSSFD SERIES

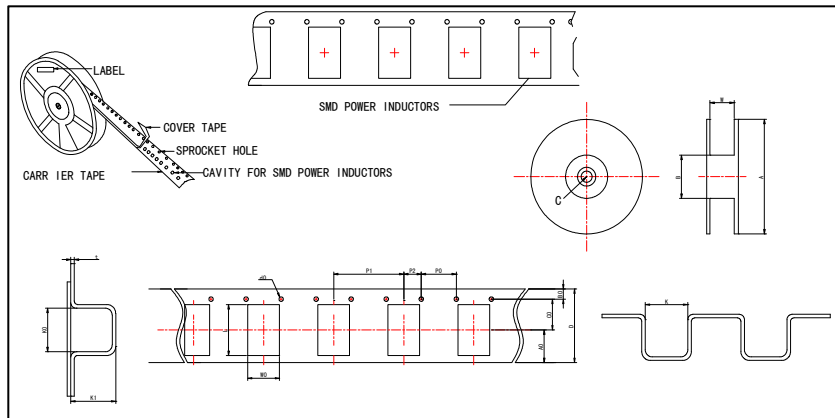

●Reel Dimensi & ons Packing Unit

UNIT:mm

Part	Number	Dimensins of Reel				Packaging Unit
		A	B	C	W	
HS-SFD2D11LD/HP		330	100.0±2.00	13.50±0.50	12.0±0.50	3000pcs/r
HS-SFD2D14L/2D18LD/HP		330	100.0±2.00	13.50±0.50	12.0±0.50	3000pcs/r
HS-SFD3D11L/3D14HP		330	100.0±2.00	13.50±0.50	12.0±0.50	3000pcs/r
HS-SFD3D16T/LD/HP/3D28L		330	100.0±2.00	13.50±0.50	12.0±0.50	2000pcs/r
HS-SFD4D14HP/4D18T		330	100.0±2.00	13.50±0.50	12.0±0.50	2000pcs/r
HS-SFD4D22T/4D28T		330	100.0±2.00	13.50±0.50	12.0±0.50	2000pcs/r
HS-SFD5D18T/5D28T		330	100.0±2.00	13.50±0.50	12.0±0.50	2000pcs/r
HS-SFD6D26T/6D28T /6D38T		330	100.0±2.00	13.50±0.50	16.0±0.50	1500/1500/1000pcs/r
HS-SFD8D28T/8D38T/8D48T		330	100.0±2.00	13.50±0.50	16.0±0.50	1000/1000/800pcs/r

●Carrier Tape Dimensions

UNIT:mm

Sym.	HS-SFD2D11LD/HP HS-SFD2D14L HS-SFD2D18LD/HP	HS-SFD3D11L HS-SFD3D14HP	HS-SFD3D16T/LD/H P HS-SFD3D28L	HS-SFD4D14HP HS-SFD4D18T HS-SFD4D22T HS-SFD4D28T	HS-SFD5D18T HS-SFD5D28T	HS-SFD6D26T HS-SFD6D28T HS-SFD6D38	HS-SFD8D28T HS-SFD8D38T HS-SFD8D43T
A0	4.75±0.10	4.75±0.10	4.75±0.10	4.75±0.10	4.75±0.10	6.75±0.10	6.75±0.10
B0	1.75±0.10	1.75±0.10	1.75±0.10	1.75±0.10	1.75±0.10	1.75±0.10	1.75±0.10
C0	5.50±0.10	5.50±0.10	5.50±0.10	5.50±0.10	5.50±0.10	7.50±0.10	7.50±0.10
D	12.00±0.30	12.00±0.30	12.00±0.30	12.00±0.30	12.00±0.30	16.00±0.30	16.00±0.30
K	3.30±0.20	4.40±0.20	4.30±0.20	5.20±0.20	6.20±0.20	7.30±0.20	8.30±0.20
K0	3.30±0.20	4.30±0.20	4.30±0.20	5.20±0.20	6.20±0.10	7.30±0.10	9.30±0.10
K1	1.20/1.65/2.1 ± 0.10	1.30/1.70 ±0.10	2.00/3.0 ±0.10	1.6/2.2/2.4/3. 2 ±0.10	2.20/3.20 ±0.10	2.9/3.10/4. 1 ±0.10	3.0/4.0/4.5 ±0.10
L	3.30±0.20	4.40±0.20	4.70±0.20	5.60±0.20	6.20±0.20	7.30±0.20	9.30±0.20
W0	3.30±0.20	4.30±0.20	4.70±0.20	5.60±0.20	6.20±0.20	7.30±0.20	8.30±0.20
P0	4.00±0.10	4.00±0.10	4.00±0.10	4.00±0.10	4.00±0.10	4.00±0.10	4.00±0.10
P1	8.00±0.10	8.00±0.10	8.00±0.10	8.00±0.10	8.00±0.10	12.00±0.10	12.00±0.10
P2	2.00±0.05	2.00±0.05	2.00±0.05	2.00±0.05	2.00±0.05	2.00±0.05	2.00±0.05
d0	1.55±0.05	1.55±0.05	1.55±0.05	1.55±0.05	1.55±0.05	1.55±0.05	1.55±0.05
t	0.30±0.05	0.30±0.05	0.30±0.05	0.40±0.05	0.40±0.05	0.40±0.05	0.40±0.05